

MULTIPLE CONFIGURATIONS WITH DOCK LOADING

// ± 3,119 SF to 12,482 SF

FOR LEASE

4709 - 14 Street NE, Units 4-7, Calgary, AB



Lead Broker

Manny Verdugo, SIOR Vice President | Associate
403.383.7142 | mverdugo@cdnglobal.com

Erik Dobrovolsky | Senior Associate
403.613.7161 | edobrovolsky@cdnglobal.com

Jose Verdugo | Associate
587.968.1547 | jverdugo@cdnglobal.com

CDN Global Advisors Ltd. 736 6th Ave SW, Suite 1010
Calgary, Alberta T2P 3T7 www.cdnglobal.com

CDNGLOBAL[®]
Commercial Real Estate Advisors

PROPERTY HIGHLIGHTS // 4709 - 14 Street NE



PROPERTY OVERVIEW

- Rare industrial bays with dock loading (12' x 12')
- Multiple configurations available from 3,119 SF to 12,482 SF
- Unit 7 available as a single bay at 3,119 SF
- 100 Amps per bay
- Tenant improvement negotiable
- Nearby to several restaurants, cafes, breweries, and a short drive to Deerfoot City Mall
- Bus transportation on 12 Street NE, including bus routes #32 and #69
- Close proximity to 12 Street NE, McKnight Boulevard and Deerfoot Trail NE
- **NOTE: Does not accommodate 53' trailers**

District:	McCall Industrial	
Zoning:	I-G (Industrial General)	
Available Units:	Unit 7:	3,119 SF
	Units 4-5:	6,250 SF
	Units 6-7:	6,232 SF
	Units 4-7:	12,482 SF
Clear Height:	18'	
Loading:	1 Dock Door (12'w x 12'h) per bay (Total of 4 Dock Doors)	
Power:	100 Amps per Bay (TBV)	
Lease Rate:	Unit 7:	\$12.50 PSF
	Double Bay:	\$11.00 PSF
	Units 4-7:	\$10.00 PSF
Operating Costs (Est. 2023):	\$6.54 PSF	
Availability:	Immediate	

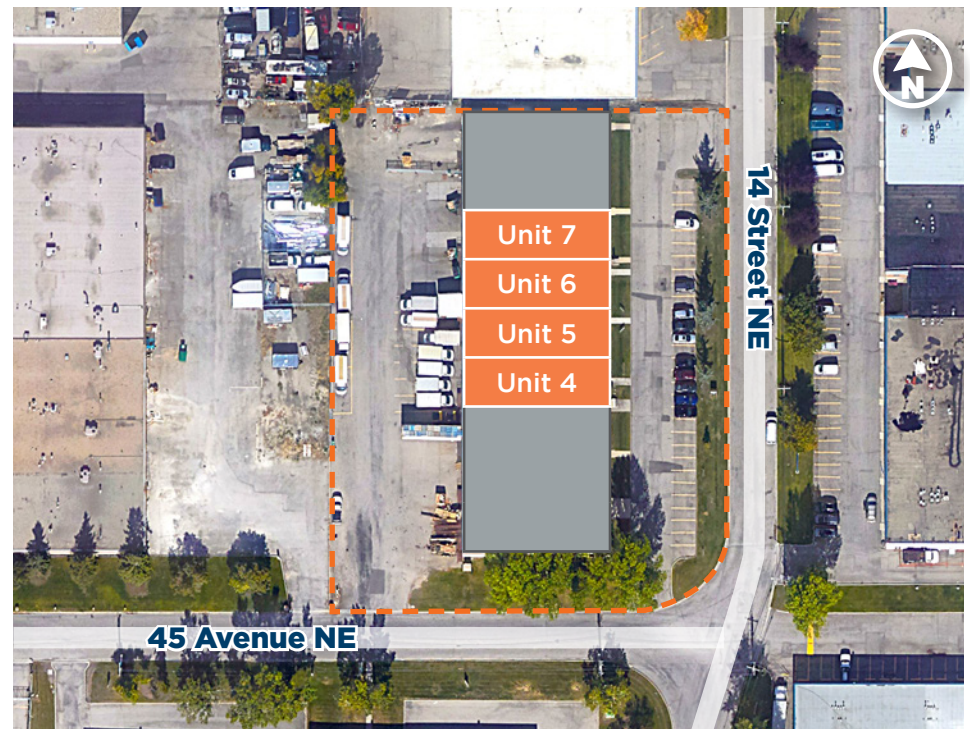



UNIT BREAKDOWN

UNIT 7

Size Breakdown	Main floor office: Warehouse: Total:	653 SF 2,466 SF ± 3,119 SF
Loading:	1 Dock Doors (12'w x 12'h)	
Power:	100 Amps (TBV)	
Lease Rate:	\$12.50 PSF	
Availability:	Immediate	

UNITS 4-5

Size Breakdown	Main floor office: Warehouse: Total: Bonus Mezzanine:	465 SF 5,785 SF ± 6,250 SF 609 SF
Loading:	2 Dock Doors (12'w x 12'h)	
Power:	2 x 100 Amps (TBV)	
Lease Rate:	\$11.00 PSF	
Availability:	Immediate	

UNITS 6-7

Size Breakdown	Main floor office: Second floor office: Warehouse: Total: Bonus Mezzanine:	1,242 SF 4,990 SF ± 6,232 SF 677 SF
Loading:	2 Dock Doors (12'w x 12'h)	
Power:	2 x 100 Amps (TBV)	
Lease Rate:	\$11.00 PSF	
Availability:	Immediate	

UNITS 4-7

Size Breakdown	Main floor office: Warehouse: Total: Bonus Mezzanine:	1,707 SF 10,775 SF ± 12,482 SF 1,286 SF
Loading:	2 Dock Doors (12'w x 12'h)	
Power:	4 x 100 Amps (TBV)	
Lease Rate:	\$10.00 PSF	
Availability:	Immediate	

UNITS 4-7

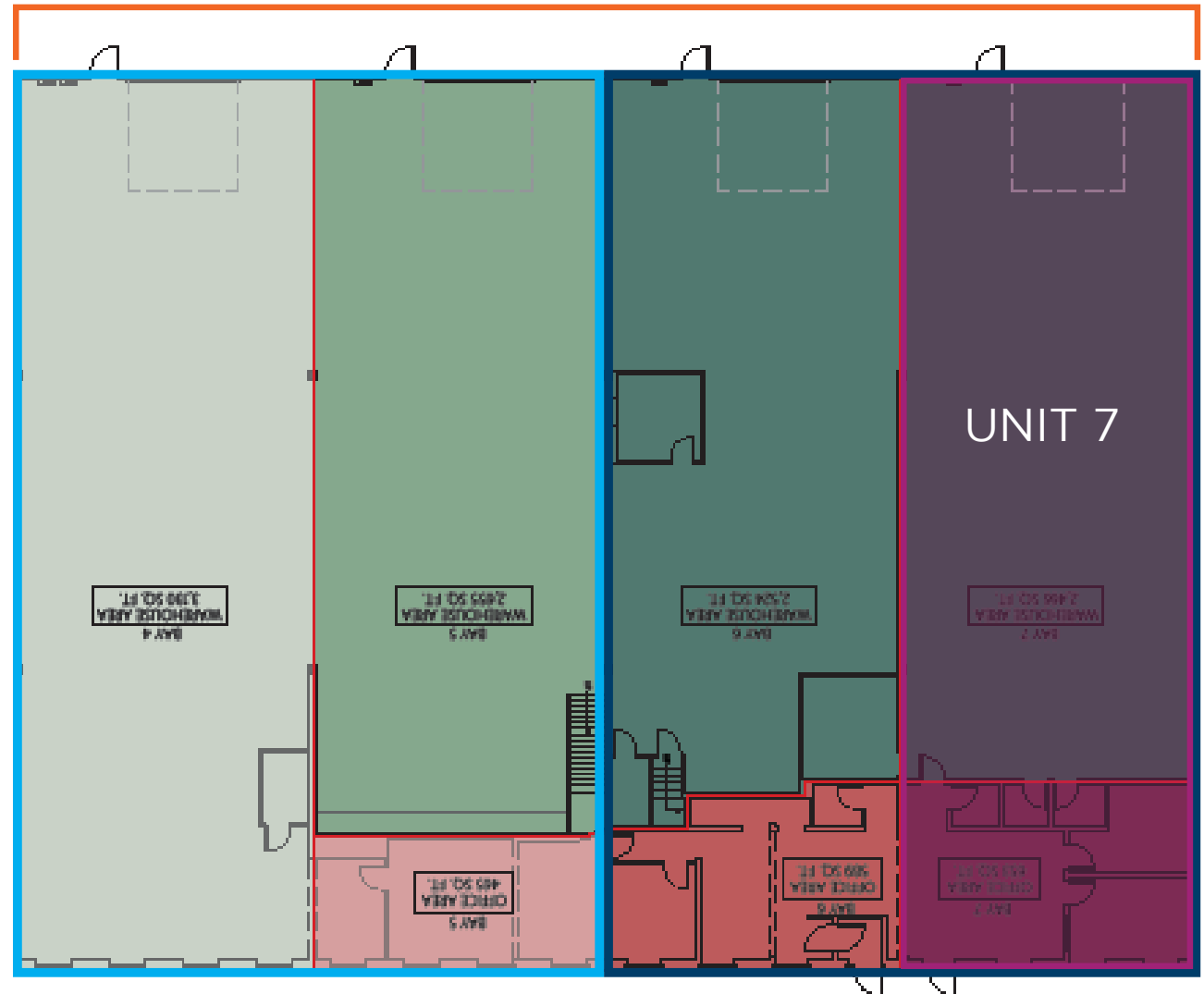

UNITS 4-5

UNITS 6-7

PROPERTY PICTURES // 4709 - 14 Street NE, Units 4-7



LOCATION



Drive Times:

McKnight Boulevard NE: **1 minute**

Deerfoot Trail NE: **2 minutes**

Calgary Airport: **10 minutes**

Downtown Calgary **10 minutes**

Nearby Amenities

Easy accessibility & close proximity to:



Close proximity to McKnight Boulevard and Deerfoot Trail NE



Bus Routes on 12 Street NE



Ample of restaurants & fast food

This communication is intended for general information only and not to be relied upon in any way. Consequently no responsibility or liability whatsoever can be accepted by CDNGLOBAL for any loss or damage resulting from any use of, reliance on or reference to the contents of this document, including hypertext links to external sources. In addition, as a general communication, this material does not necessarily represent the view of CDNGLOBAL in relation to particular properties or projects. This communication is not intended to cause or induce breach of any agency agreement. Reproduction or distribution of this communication in whole or in part is not allowed without prior written approval of CDNGLOBAL.